

ML Uno

TECHNICAL DATA

Part #: 135101000



ML Uno is the smallest unit from the ML family. The size of the unit is that of a small spot lamp. It is well suited for low-ceiling rooms, even where a high replacement of air is required, and is because of its invisibility well suited for any purpose.

ML Uno is installed directly on wall or ceiling at a height of min. 6 ½ feet, and is connected to the ML pump station by flexible high-pressure hoses.

The water is atomized under high pressure into microscopic particles evaporating immediately.



ML Uno is compatible with other humidification pump stations from Nortec.

ML Uno is delivered as a unit with wall or ceiling fixture.

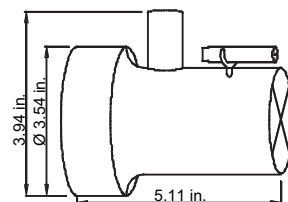

Technical data for ML Uno:	1 ML Uno Unit	2 ML Uno Units	3 ML Uno Units
Item No.	135101000	135102000	135103000
Weight	Approx. 0.66 lbs.	Approx. 1.32 lbs.	Approx. 1.98 lbs.
Size (H x W x D) inches	3.94 x 3.54 x 5.11	3.94 x 3.54 x 5.11	3.94 x 3.54 x 5.11
Material	Aluminum	Aluminum	Aluminum
Noise level	~ 40 dB	~ 40 dB	~ 40 dB
Humidity capacity	2.2 – 3.3 lbs/hr	4.4 – 6.6 lbs/hr	6.6 - 10 lbs/hr
Working pressure	507 - 1015 psi	507 - 1015 psi	507 - 1015 psi
Supply Voltage	24 VAC 50/60 Hz	24 VAC 50/60 Hz	24 VAC 50/60 Hz
Installation height	6.5 - 13 feet	6.5 - 13 feet	6.5 - 13 feet
Min. Distance to ceiling	7 ½ inches	7 ½ inches	7 ½ inches
Clearance in front of nozzle	6.5 – 9.8 feet	6.5 – 9.8 feet	6.5 – 9.8 feet
Nozzle type	1 pc. MLN 100 AF	2 pc. MLN 100 AF	3 pc. MLN 100 AF
Speed controller	Included	Included	Included